

REV.	ECN. NO.	APPD.
A	WL-20-008	Jerry. Zhang

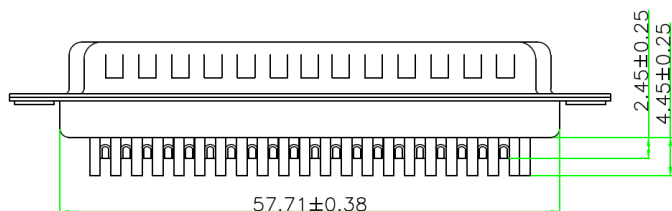
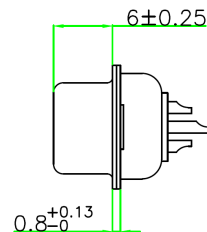
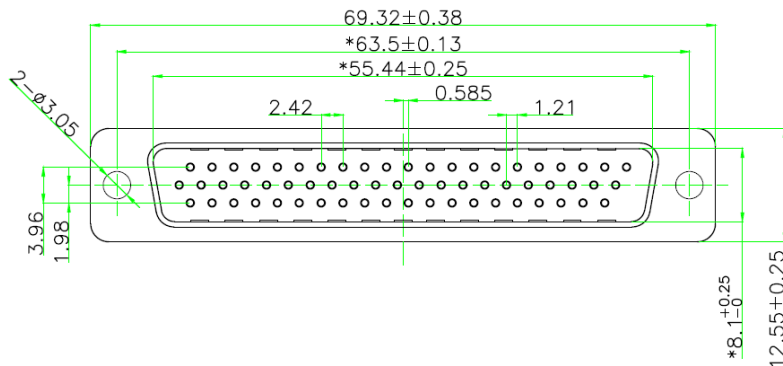

NOTICE :

1. ELECTRICICE:

- DIELECTRIC RATING: 300V
- CONTACT CURRENT RATING: 3AMP
- CONTACT RESISTANCE: 15mΩ MAX.
- INSULATION RESISTANCE: 1000MΩ MIN. AT 500V DC
- DIELECTRIC STRENGTH: 500V AC RMS FOR 1MINUTE
- OPERATION TEMPERATURE: -55C° ~125C°

2. MATERIAL:

- INSULATOR: PBT+30% G. F (UL94V-0)
- CONTACT: COPPER ALLOY
- CONTACT PLATED: GOLD FIASH OVER NICKEL
- SHELL: SPCC
- SHELL PLATED: NICKEL/TIN

IDEAS GENERATED DRAWING. DON'T CHANGE BY HAND.

X.±	X.±	UNITS mm	NAME(INTENDED USE) HDB 62P 母 焊线式传统铆合	
.X± 0.3	.X'±	MAT'L	PART NO.(INTENDED USE) WL11-5701	
.XX± 0.20	.XX'±	SEE NOTES		APPD: yuan. wu 08/16"20
.XXX±	.XXX'±	FINISH	CHKD: lei. wang 08/16"20	TITLE: CONN DRAWING
THESE DRAWINGS AND SPECIFICATIONS ARE THE PROPERTY OF INCEL INTERCONNECT TECHNOLOGY LIMITED, AND SHALL NOT BE REPRODUCED, COPIED OR USED IN ANY MANNER WITHOUT THE PRIOR WRITTEN CONSENT OF INCEL INTERCONNECT TECHNOLOGY LIMITED.			Q'TY	DWG NO.: WL11-5701-0004
			DRAW: min. sun 08/16"20	SCALE SHEET REV. N/A 1/1 A